

Surface Mount Shielded Power Inductors

Surface Mount Shielded Power Inductors SDS Series (表面接著型閉磁式功率電感-----SDS 系列)



Features(特徵):

1. Low DC resistance and for large currents.(適合低阻抗及大電流。)
2. Closed magnetic circuit crosstalk.(閉合磁路可抗干擾。)
3. S.M.T. type.(表面黏著類型。)
4. Suitable for and reflow soldering.(適合於一般焊接及回焊。)
5. Available in various sizes.(不同呎吋規格可供選擇。)
6. Excellent solderability and heat resistance.(良好的焊錫性及耐熱性。)
7. High reliability.(高可靠度。)

Applications(應用):

Excellent as VTR, OA equipment, LCD television sets, notebook PC, portable communication equipments, DC/DC converters, etc.

適用於錄影機、OA 儀器、液晶電視、筆記型電腦、小型通信機器、DC/DC 轉換器等。

Shape & Dimensions(外觀呎吋):

SDS0420/0518/0520/0530 Type:

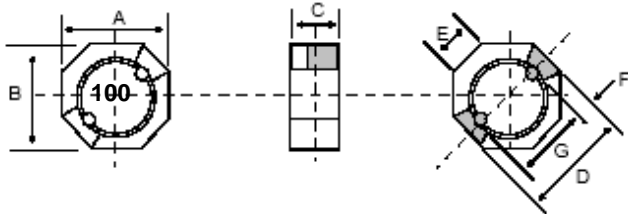

SDS0610/0620/0625/0630/0635/1007/1203/ 1205/1206/1208 Type:

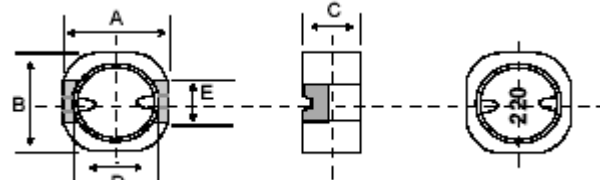

Part No.	A (mm)	B (mm)	C (mm)	D (mm)	E (mm)	F (mm)	G (mm)
SDS0420	4.30 Max	4.30 Max	2.00 Max	4.40 Max	1.60 Typ.	0.50 Typ.	2.70 Typ.
SDS0518	5.30 Max	5.30 Max	1.80 Max	5.80 Max	1.60 Typ.	0.60 Typ.	4.20 Typ.
SDS0520	5.30 Max	5.30 Max	2.00 Max	5.80 Max	1.60 Typ.	0.60 Typ.	4.20 Typ.
SDS0530	5.30 Max	5.30 Max	3.00 Max	5.80 Max	1.60 Typ.	0.60 Typ.	4.20 Typ.
SDS0610	6.30 Max	6.30 Max	1.10 Max	4.80 Typ.	2.00 Typ.	-	-
SDS0620	6.30 Max	6.30 Max	2.00 Max	4.80 Typ.	2.00 Typ.	-	-
SDS0625	6.30 Max	6.30 Max	2.50 Max	4.80 Typ.	2.00 Typ.	-	-
SDS0630	6.30 Max	6.30 Max	3.00 Max	4.80 Typ.	2.00 Typ.	-	-
SDS0635	6.30 Max	6.30 Max	3.50 Max	4.80 Typ.	2.00 Typ.	-	-
SDS1203	12.7 Max	12.7 Max	3.50 Max	10.5 Typ.	6.00 Typ.	-	-
SDS1205	12.7 Max	12.7 Max	5.00 Max	10.5 Typ.	6.00 Typ.	-	-
SDS1206	12.7 Max	12.7 Max	6.50 Max	10.5 Typ.	6.00 Typ.	-	-
SDS1208	12.7 Max	12.7 Max	8.50 Max	10.5 Typ.	6.00 Typ.	-	-

Specification(規格):

SDS0420 Series:

Part No.	Inductance (μ H)	Test Frequency	DC Resistance (Ohms) Max	Rated Current (Amp) Max
SDS0420-1R0M	1.0 \pm 20%	100KHZ/1.0V	0.028	2.00
SDS0420-1R2M	1.2 \pm 20%	100KHZ/1.0V	0.040	1.70
SDS0420-2R2M	2.2 \pm 20%	100KHZ/1.0V	0.073	1.50
SDS0420-3R5M	3.5 \pm 20%	100KHZ/1.0V	0.120	1.30
SDS0420-4R7M	4.7 \pm 20%	100KHZ/1.0V	0.160	1.10
SDS0420-6R8M	6.8 \pm 20%	100KHZ/1.0V	0.210	0.90
SDS0420-100M	10 \pm 20%	100KHZ/1.0V	0.450	0.70

Surface Mount Shielded Power Inductors

SDS0420 Series:

Part No.	Inductance (μ H)	Test Frequency	DC Resistance (Ohms) Max	Rated Current (Amp) Max
SDS0420-150M	15 \pm 20%	100KHZ/1.0V	0.481	0.61
SDS0420-220M	22 \pm 20%	100KHZ/1.0V	0.720	0.52
SDS0420-330M	33 \pm 20%	100KHZ/1.0V	1.010	0.43
SDS0420-470M	47 \pm 20%	100KHZ/1.0V	1.780	0.34
SDS0420-680M	68 \pm 20%	100KHZ/1.0V	2.770	0.25
SDS0420-101M	100 \pm 20%	100KHZ/1.0V	3.440	0.19

SDS0518 Series:

Part No.	Inductance (μ H)	Test Frequency	DC Resistance (Ohms) Max	Rated Current (Amp) Max
SDS0518-1R2M	1.2 \pm 20%	100KHZ/1.0V	0.046	1.80
SDS0518-1R8M	1.8 \pm 20%	100KHZ/1.0V	0.054	1.60
SDS0518-2R3M	2.3 \pm 20%	100KHZ/1.0V	0.063	1.50
SDS0518-3R6M	3.6 \pm 20%	100KHZ/1.0V	0.082	1.20
SDS0518-4R3M	4.3 \pm 20%	100KHZ/1.0V	0.092	1.10
SDS0518-5R1M	5.1 \pm 20%	100KHZ/1.0V	0.105	1.00
SDS0518-6R8M	6.8 \pm 20%	100KHZ/1.0V	0.130	0.94
SDS0518-100M	10 \pm 20%	100KHZ/1.0V	0.180	0.80
SDS0518-150M	15 \pm 20%	100KHZ/1.0V	0.270	0.64
SDS0518-180M	18 \pm 20%	100KHZ/1.0V	0.320	0.56
SDS0518-220M	22 \pm 20%	100KHZ/1.0V	0.450	0.49
SDS0518-330M	33 \pm 20%	100KHZ/1.0V	0.640	0.41
SDS0518-470M	47 \pm 20%	100KHZ/1.0V	0.930	0.33

SDS0520 Series:

Part No.	Inductance (μ H)	Test Frequency	DC Resistance () Max	Isat (A) Max	Irms (A) Max
SDS0520-1R2M	1.2 \pm 20%	100KHZ/1.0V	0.044	2.15	2.29
SDS0520-2R2M	2.2 \pm 20%	100KHZ/1.0V	0.059	1.63	1.64
SDS0520-3R5M	3.5 \pm 20%	100KHZ/1.0V	0.073	1.34	1.45
SDS0520-4R7M	4.7 \pm 20%	100KHZ/1.0V	0.087	1.14	1.22
SDS0520-6R8M	6.8 \pm 20%	100KHZ/1.0V	0.105	0.95	1.10
SDS0520-100M	10 \pm 20%	100KHZ/1.0V	0.150	0.76	0.87
SDS0520-150M	15 \pm 20%	100KHZ/1.0V	0.210	0.63	0.72
SDS0520-220M	22 \pm 20%	100KHZ/1.0V	0.275	0.56	0.66
SDS0520-330M	33 \pm 20%	100KHZ/1.0V	0.455	0.44	0.48
SDS0520-470M	47 \pm 20%	100KHZ/1.0V	0.730	0.36	0.35
SDS0520-680M	68 \pm 20%	100KHZ/1.0V	0.935	0.30	0.33
SDS0520-101M	100 \pm 20%	100KHZ/1.0V	1.500	0.23	0.24

SDS0530 (A Type) Series:

Part No.	Inductance (μ H)	Test Frequency	DC Resistance () Max	Isat (A) Max	Irms (A) Max
SDS0530-1R1MA	1.1 \pm 20%	100KHZ/1.0V	0.020	3.87	3.25
SDS0530-2R0MA	2.0 \pm 20%	100KHZ/1.0V	0.027	2.92	2.64
SDS0530-3R3MA	3.3 \pm 20%	100KHZ/1.0V	0.034	2.36	2.26
SDS0530-4R7MA	4.7 \pm 20%	100KHZ/1.0V	0.045	1.87	2.01

Surface Mount Shielded Power Inductors

SDS0530 (A Type) Series:

Part No.	Inductance (μH)	Test Frequency	DC Resistance () Max	Isat (A) Max	Irms (A) Max
SDS0530-6R8MA	6.8±20%	100KHZ/1.0V	0.068	1.51	1.65
SDS0530-100MA	10±20%	100KHZ/1.0V	0.090	1.33	1.41
SDS0530-150MA	15±20%	100KHZ/1.0V	0.142	1.05	1.10
SDS0530-220MA	22±20%	100KHZ/1.0V	0.208	0.86	0.81
SDS0530-330MA	33±20%	100KHZ/1.0V	0.257	0.72	0.75
SDS0530-470MA	47±20%	100KHZ/1.0V	0.352	0.62	0.64
SDS0530-680MA	68±20%	100KHZ/1.0V	0.525	0.51	0.52
SDS0530-101MA	100±20%	100KHZ/1.0V	0.801	0.43	0.44

SDS0530 (B Type) Series:

Part No.	Inductance (μH)	Test Frequency	DC Resistance () Max	Isat (A) Max	Irms (A) Max
SDS0530-4R7MB	4.7±20%	100KHZ/1.0V	0.035	1.13	2.18
SDS0530-6R8MB	6.8±20%	100KHZ/1.0V	0.050	0.99	1.81
SDS0530-100MB	10±20%	100KHZ/1.0V	0.067	0.74	1.50
SDS0530-150MB	15±20%	100KHZ/1.0V	0.097	0.58	1.28
SDS0530-220MB	22±20%	100KHZ/1.0V	0.135	0.51	1.12
SDS0530-330MB	33±20%	100KHZ/1.0V	0.206	0.41	0.88
SDS0530-470MB	47±20%	100KHZ/1.0V	0.268	0.34	0.75
SDS0530-680MB	68±20%	100KHZ/1.0V	0.371	0.29	0.64
SDS0530-101MB	100±20%	100KHZ/1.0V	0.569	0.26	0.51
SDS0530-151MB	150±20%	100KHZ/1.0V	0.940	0.21	0.38
SDS0530-221MB	220±20%	100KHZ/1.0V	1.200	0.18	0.33

SDS0610 Series:

Part No.	Inductance (uH)	Test Frequency	DC Resistance (Ohms) Max	Rated Current (Amp) Max
SDS0610-2R2M	2.2±20%	100KHZ/1.0V	0.13	1.50
SDS0610-4R7M	4.7±20%	100KHZ/1.0V	0.27	1.09
SDS0610-6R8M	6.8±20%	100KHZ/1.0V	0.35	1.00
SDS0610-100M	10.0±20%	100KHZ/1.0V	0.45	0.80
SDS0610-150M	15.0±20%	100KHZ/1.0V	0.55	0.65
SDS0610-220M	22.0±20%	100KHZ/1.0V	0.90	0.50
SDS0610-470M	47.0±20%	100KHZ/1.0V	2.80	0.32
SDS0610-101M	100±20%	100KHZ/1.0V	3.50	0.19

SDS0620 Series:

Part No.	Inductance (μH)	Test Frequency	DC Resistance () Max	Isat (A) Max	Irms (A) Max
SDS0620-1R0M	1.0±20%	100KHZ/1.0V	0.016	3.50	3.48
SDS0620-1R5M	1.5±20%	100KHZ/1.0V	0.021	2.94	2.99
SDS0620-2R0M	2.0±20%	100KHZ/1.0V	0.028	2.47	2.33
SDS0620-3R3M	3.3±20%	100KHZ/1.0V	0.047	1.99	1.97
SDS0620-4R7M	4.7±20%	100KHZ/1.0V	0.065	1.59	1.54
SDS0620-6R2M	6.2±20%	100KHZ/1.0V	0.074	1.49	1.45

Surface Mount Shielded Power Inductors

SDS0620 Series:

Part No.	Inductance (μH)	Test Frequency	DC Resistance () Max	Isat (A) Max	Irms (A) Max
SDS0620-8R2M	8.2±20%	100KHZ/1.0V	0.102	1.25	1.23
SDS0620-100M	10±20%	100KHZ/1.0V	0.118	1.22	1.09
SDS0620-120M	12±20%	100KHZ/1.0V	0.153	0.99	1.10
SDS0620-150M	15±20%	100KHZ/1.0V	0.197	0.94	0.82
SDS0620-180M	18±20%	100KHZ/1.0V	0.207	0.83	0.90
SDS0620-220M	22±20%	100KHZ/1.0V	0.253	0.80	0.74
SDS0620-270M	27±20%	100KHZ/1.0V	0.330	0.65	0.65
SDS0620-330M	33±20%	100KHZ/1.0V	0.368	0.63	0.61
SDS0620-390M	39±20%	100KHZ/1.0V	0.473	0.55	0.56
SDS0620-470M	47±20%	100KHZ/1.0V	0.542	0.50	0.52

SDS0625 Series:

Part No.	Inductance (μH)	Test Frequency	DC Resistance () Max	Isat (A) Max	Irms (A) Max
SDS0625-1R0M	1.0±20%	100KHZ/1.0V	0.014	3.48	3.84
SDS0625-1R5M	1.5±20%	100KHZ/1.0V	0.018	2.83	3.40
SDS0625-2R0M	2.0±20%	100KHZ/1.0V	0.020	2.44	3.10
SDS0625-3R3M	3.3±20%	100KHZ/1.0V	0.030	1.89	2.55
SDS0625-4R3M	4.3±20%	100KHZ/1.0V	0.039	1.65	2.23
SDS0625-6R2M	6.2±20%	100KHZ/1.0V	0.054	1.37	1.85
SDS0625-100M	10±20%	100KHZ/1.0V	0.080	1.07	1.48
SDS0625-120M	12±20%	100KHZ/1.0V	0.094	0.97	1.35
SDS0625-150M	15±20%	100KHZ/1.0V	0.109	0.87	1.24
SDS0625-180M	18±20%	100KHZ/1.0V	0.138	0.79	1.11
SDS0625-220M	22±20%	100KHZ/1.0V	0.163	0.71	1.00
SDS0625-270M	27±20%	100KHZ/1.0V	0.212	0.64	0.86
SDS0625-330M	33±20%	100KHZ/1.0V	0.244	0.58	0.80
SDS0625-390M	39±20%	100KHZ/1.0V	0.306	0.53	0.70
SDS0625-470M	47±20%	100KHZ/1.0V	0.363	0.48	0.63
SDS0625-560M	56±20%	100KHZ/1.0V	0.431	0.44	0.58
SDS0625-680M	68±20%	100KHZ/1.0V	0.500	0.40	0.53
SDS0625-820M	82±20%	100KHZ/1.0V	0.580	0.36	0.49
SDS0625-101M	100±20%	100KHZ/1.0V	0.820	0.33	0.43

SDS0630 Series:

Part No.	Inductance (μH)	Test Frequency	DC Resistance () Max	Isat (A) Max	Irms (A) Max
SDS0630-1R0M	1.0±20%	100KHZ/1.0V	0.014	3.59	4.03
SDS0630-1R5M	1.5±20%	100KHZ/1.0V	0.016	2.93	3.63
SDS0630-2R2M	2.2±20%	100KHZ/1.0V	0.020	2.42	3.30
SDS0630-3R6M	3.6±20%	100KHZ/1.0V	0.026	1.89	2.83
SDS0630-4R7M	4.7±20%	100KHZ/1.0V	0.034	1.66	2.45
SDS0630-6R2M	6.2±20%	100KHZ/1.0V	0.040	1.45	2.20
SDS0630-100M	10±20%	100KHZ/1.0V	0.061	1.14	1.77
SDS0630-120M	12±20%	100KHZ/1.0V	0.065	1.04	1.70

Surface Mount Shielded Power Inductors

SDS0630 Series:

Part No.	Inductance (μH)	Test Frequency	DC Resistance () Max	Isat (A) Max	Irms (A) Max
SDS0630-150M	15±20%	100KHZ/1.0V	0.078	0.93	1.55
SDS0630-180M	18±20%	100KHZ/1.0V	0.093	0.85	1.41
SDS0630-220M	22±20%	100KHZ/1.0V	0.119	0.77	1.23
SDS0630-270M	27±20%	100KHZ/1.0V	0.150	0.70	1.08
SDS0630-330M	33±20%	100KHZ/1.0V	0.175	0.63	0.99
SDS0630-390M	39±20%	100KHZ/1.0V	0.188	0.58	0.95
SDS0630-470M	47±20%	100KHZ/1.0V	0.231	0.53	0.84
SDS0630-560M	56±20%	100KHZ/1.0V	0.275	0.48	0.76
SDS0630-680M	68±20%	100KHZ/1.0V	0.338	0.44	0.69
SDS0630-820M	82±20%	100KHZ/1.0V	0.413	0.40	0.61
SDS0630-101M	100±20%	100KHZ/1.0V	0.519	0.36	0.54
SDS0630-151M	150±20%	100KHZ/1.0V	0.769	0.31	0.42

SDS0635 Series:

Part No.	Inductance (μH)	Test Frequency	DC Resistance () Max	Isat (A) Max	Irms (A) Max
SDS0635-2R0M	2.0±20%	100KHZ/1.0V	0.020	2.997	3.30
SDS0635-2R7M	2.7±20%	100KHZ/1.0V	0.023	2.691	3.12
SDS0635-3R3M	3.3±20%	100KHZ/1.0V	0.027	2.573	2.81
SDS0635-4R7M	4.7±20%	100KHZ/1.0V	0.033	2.084	2.51
SDS0635-6R2M	6.2±20%	100KHZ/1.0V	0.036	1.835	2.41
SDS0635-8R2M	8.2±20%	100KHZ/1.0V	0.045	1.542	2.11
SDS0635-100M	10±20%	100KHZ/1.0V	0.052	1.491	1.97
SDS0635-120M	12±20%	100KHZ/1.0V	0.065	1.282	1.73
SDS0635-150M	15±20%	100KHZ/1.0V	0.080	1.103	1.54
SDS0635-180M	18±20%	100KHZ/1.0V	0.085	1.046	1.52
SDS0635-220M	22±20%	100KHZ/1.0V	0.111	0.968	1.29
SDS0635-270M	27±20%	100KHZ/1.0V	0.146	0.821	1.11
SDS0635-330M	33±20%	100KHZ/1.0V	0.169	0.755	1.02
SDS0635-390M	39±20%	100KHZ/1.0V	0.199	0.700	0.96
SDS0635-470M	47±20%	100KHZ/1.0V	0.218	0.677	0.89
SDS0635-560M	56±20%	100KHZ/1.0V	0.268	0.602	0.80
SDS0635-680M	68±20%	100KHZ/1.0V	0.333	0.556	0.71
SDS0635-820M	82±20%	100KHZ/1.0V	0.436	0.468	0.61
SDS0635-101M	100±20%	100KHZ/1.0V	0.496	0.449	0.57
SDS0635-151M	150±20%	100KHZ/1.0V	0.691	0.367	0.48

SDS1203 Series:

Part No.	Inductance (μH)	Test Frequency	DC Resistance (Ohms) Max	Rated Current (Amp) Max
SDS1203-1R0M	1.0±20%	100KHz/1.0V	0.011	12.0
SDS1203-2R2M	2.2±20%	100KHz/1.0V	0.017	11.0
SDS1203-3R3M	3.3±20%	100KHz/1.0V	0.022	9.9
SDS1203-4R7M	4.7±20%	100KHz/1.0V	0.032	8.8
SDS1203-5R6M	5.6±20%	100KHz/1.0V	0.031	7.7

Surface Mount Shielded Power Inductors

SDS1203 Series:

Part No.	Inductance (μ H)	Test Frequency	DC Resistance (Ohms) Max	Rated Current (Amp) Max
SDS1203-6R8M	6.8 \pm 20%	100KHz/1.0V	0.045	6.6
SDS1203-8R2M	8.2 \pm 20%	100KHz/1.0V	0.048	5.5
SDS1203-100M	10 \pm 20%	100KHz/1.0V	0.062	4.5
SDS1203-120M	12 \pm 20%	100KHz/1.0V	0.065	3.4
SDS1203-150M	15 \pm 20%	100KHz/1.0V	0.077	3.2
SDS1203-180M	18 \pm 20%	100KHz/1.0V	0.088	2.9
SDS1203-220M	22 \pm 20%	100KHz/1.0V	0.097	2.6
SDS1203-330M	33 \pm 20%	100KHz/1.0V	0.153	2.4
SDS1203-470M	47 \pm 20%	100KHz/1.0V	0.246	2.1
SDS1203-680M	68 \pm 20%	100KHz/1.0V	0.325	1.6
SDS1203-101M	100 \pm 20%	100KHz/1.0V	0.464	1.1

SDS1205 Series:

Part No.	Inductance (μ H)	Test Frequency	DC Resistance (Ohms) Max	Rated Current (Amp) Max
SDS1205-1R5M	1.5 \pm 20%	100KHz/1.0V	0.005	8.10
SDS1205-2R5M	2.5 \pm 20%	100KHz/1.0V	0.008	7.30
SDS1205-3R8M	3.8 \pm 20%	100KHz/1.0V	0.015	6.50
SDS1205-5R2M	5.2 \pm 20%	100KHz/1.0V	0.018	5.70
SDS1205-7R0M	7.0 \pm 20%	100KHz/1.0V	0.023	4.90
SDS1205-100M	10 \pm 20%	100KHz/1.0V	0.028	4.50
SDS1205-150M	15 \pm 20%	100KHz/1.0V	0.050	3.20
SDS1205-220M	22 \pm 20%	100KHz/1.0V	0.066	2.90
SDS1205-330M	33 \pm 20%	100KHz/1.0V	0.097	2.70
SDS1205-470M	47 \pm 20%	100KHz/1.0V	0.160	1.90
SDS1205-680M	68 \pm 20%	100KHz/1.0V	0.220	1.50
SDS1205-101M	100 \pm 20%	100KHz/1.0V	0.308	1.20
SDS1205-151M	150 \pm 20%	100KHz/1.0V	0.530	0.95
SDS1205-221M	220 \pm 20%	100KHz/1.0V	0.700	0.80
SDS1205-331M	330 \pm 20%	100KHz/1.0V	0.990	0.50

SDS1206 Series:

Part No.	Inductance (μ H)	Test Frequency	DC Resistance (Ohms) Max	Rated Current (Amp) Max
SDS1206-100M	10.0 \pm 20%	100KHz/1.0V	0.025	4.00
SDS1206-120M	12.0 \pm 20%	100KHz/1.0V	0.027	3.50
SDS1206-150M	15.0 \pm 20%	100KHz/1.0V	0.030	3.30
SDS1206-180M	18.0 \pm 20%	100KHz/1.0V	0.034	3.00
SDS1206-220M	22.0 \pm 20%	100KHz/1.0V	0.036	2.80
SDS1206-270M	27.0 \pm 20%	100KHz/1.0V	0.051	2.30
SDS1206-330M	33.0 \pm 20%	100KHz/1.0V	0.057	2.10
SDS1206-390M	39.0 \pm 20%	100KHz/1.0V	0.068	2.00
SDS1206-470M	47.0 \pm 20%	100KHz/1.0V	0.075	1.80
SDS1206-560M	56.0 \pm 20%	100KHz/1.0V	0.110	1.70
SDS1206-680M	68.0 \pm 20%	100KHz/1.0V	0.120	1.50

Surface Mount Shielded Power Inductors

SDS1206 Series:

Part No.	Inductance (μ H)	Test Frequency	DC Resistance (Ohms) Max	Rated Current (Amp) Max
SDS1206-820M	82.0 \pm 20%	100KHz/1.0V	0.140	1.40
SDS1206-101M	100.0 \pm 20%	100KHz/1.0V	0.160	1.30
SDS1206-121M	120.0 \pm 20%	100KHz/1.0V	0.170	1.10
SDS1206-151M	150.0 \pm 20%	100KHz/1.0V	0.230	1.00
SDS1206-181M	180.0 \pm 20%	100KHz/1.0V	0.290	0.90
SDS1206-221M	220.0 \pm 20%	100KHz/1.0V	0.400	0.80
SDS1206-271M	270.0 \pm 20%	100KHz/1.0V	0.460	0.75

SDS1208 Series:

Part No.	Inductance (μ H)	Test Frequency	DC Resistance (Ohms) Max	Rated Current (Amp) Max
SDS1208-1R2M	1.20 \pm 20%	100KHz/1.0V	0.005	9.80
SDS1208-2R4M	2.40 \pm 20%	100KHz/1.0V	0.011	8.00
SDS1208-3R5M	3.50 \pm 20%	100KHz/1.0V	0.013	7.50
SDS1208-4R7M	4.70 \pm 20%	100KHz/1.0V	0.015	6.80
SDS1208-6R1M	6.10 \pm 20%	100KHz/1.0V	0.017	6.60
SDS1208-7R6M	7.60 \pm 20%	100KHz/1.0V	0.020	5.90
SDS1208-100M	10.0 \pm 20%	100KHz/1.0V	0.021	5.40
SDS1208-120M	12.0 \pm 20%	100KHz/1.0V	0.024	4.90
SDS1208-150M	15.0 \pm 20%	100KHz/1.0V	0.027	4.50
SDS1208-180M	18.0 \pm 20%	100KHz/1.0V	0.039	3.90
SDS1208-220M	22.0 \pm 20%	100KHz/1.0V	0.043	3.60
SDS1208-270M	27.0 \pm 20%	100KHz/1.0V	0.045	3.40
SDS1208-330M	33.0 \pm 20%	100KHz/1.0V	0.064	3.00
SDS1208-390M	39.0 \pm 20%	100KHz/1.0V	0.072	2.75
SDS1208-470M	47.0 \pm 20%	100KHz/1.0V	0.100	2.50
SDS1208-560M	56.0 \pm 20%	100KHz/1.0V	0.110	2.35
SDS1208-680M	68.0 \pm 20%	100KHz/1.0V	0.140	2.10
SDS1208-820M	82.0 \pm 20%	100KHz/1.0V	0.160	1.95
SDS1208-101M	100.0 \pm 20%	100KHz/1.0V	0.220	1.70

Note:

- (1) Inductance is measured by LCR-meter 4284A (HP) or equivalent.
- (2) DC Resistance is measured by HP4338B Milliohms Meter or equivalent.
- (3) Rated current is measured by LCR-meter 3260B (WK) & DC Bias 3265B(WK).
- (3) Maximum allowable DC current is that which causes a 30% inductance reduction from the initial value, or coil temperature to rise by 40°C, whichever is smaller. (Reference ambient temperature 20°C).