

Radial Choke Coils PK Series(徑向電感線圈-----PK 系列)



● Features(特徵):

1. High rated current for High current circuits.
Designed by special lead wire to prevent open circuit failure.. (高定格電流以適為高電流電路板設計特殊導針來預防開路。)
2. Low cost with rugged reliability and performance fixed inductor.(低成本且具有嚴格的可靠度及表現一致的電感。)

● Applications(應用):

Excellent as DC-DC converter boost or buck inductors. Also used for filtering applications.

適合用於直流—直流整流器或作為低階電感，也可用於濾波應用。

● Shape & Dimensions(外觀呎吋):

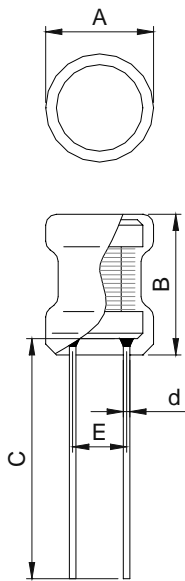

Dimensions					
Item	A(mm)	B(mm)	C(mm)	d(mm)	E(mm)
PK0406	5.5 Max	8.0 Max	25.0 Typ.	0.50 typ.	1.8±0.5 2.0±0.5
PK0608	7.5 Max	10.0 Max	25.0 Typ.	0.60 typ.	2.6±0.5 3.0±0.5 3.5±0.5
PK0810	10.5 Max	12.0 Max	25.0 Typ.	0.65 typ.	4.0±0.5 4.5±0.5 5.0±0.5
PK0912	11.5 Max	14.0 Max	25.0 Typ.	0.80 typ.	5.0±0.5 5.5±0.5 6.0±0.5
PK1012	11.5 Max	14.0 Max	25.0 Typ.	0.80 typ.	5.0±0.5 6.0±0.5 7.0±0.5
PK1016	11.5 Max	18.0 Max	25.0 Typ.	0.80 typ.	7.5±0.5

*When the product need add UL tube (U Type), the dimension depends on U type dimension. If not, the dimension is the trim size.以下為產品加 UL 套管時的呎吋，(即為 U Type 的呎吋)，其它型式的產品呎吋以實際產品而定的規格書為準。

● Specification(規格):

◆ PK0406 Series:

Part Number	Inductance (μH)	Test Frequency (KHz)	DC Resistance (Ohms) Max	Rated Current (A) Max
PK0406-1R0□	1.0	1	0.030	3.00
PK0406-1R5□	1.5	1	0.035	2.80
PK0406-1R8□	1.8	1	0.040	2.70
PK0406-2R2□	2.2	1	0.045	2.50
PK0406-2R7□	2.7	1	0.050	2.50
PK0406-3R3□	3.3	1	0.055	2.20
PK0406-3R9□	3.9	1	0.060	2.10
PK0406-4R7□	4.7	1	0.065	2.00
PK0406-5R6□	5.6	1	0.07	1.80
PK0406-6R8□	6.8	1	0.08	1.70
PK0406-8R2□	8.2	1	0.09	1.50

Lead Type Fixed Inductors

Part Number	Inductance (μH)	Test Frequency (KHz)	DC Resistance (Ohms) Max	Rated Current (A) Max
PK0406-100□	10	1	0.11	1.40
PK0406-120□	12	1	0.14	1.20
PK0406-150□	15	1	0.16	1.10
PK0406-180□	18	1	0.18	1.00
PK0406-220□	22	1	0.25	0.90
PK0406-270□	27	1	0.37	0.80
PK0406-330□	33	1	0.42	0.70
PK0406-390□	39	1	0.45	0.70
PK0406-470□	47	1	0.50	0.60
PK0406-560□	56	1	0.56	0.60
PK0406-680□	68	1	0.63	0.55
PK0406-820□	82	1	0.77	0.50
PK0406-101□	100	1	0.85	0.40

Note: □: Tolerance J: ±5% K: ±10% L: ±15% M: ±20%

Test Equipment Inductance:Hp4284A LCR Meter / DC Resistance:HP4338B Milliohms Meter.

◆PK0608 Series:

Part Number	Inductance (μH)	Test Frequency (KHz)	DC Resistance (Ohms) Max	Rated Current (A) Max
PK0608-1R0□	1.0	1	0.015	3.00
PK0608-1R2□	1.2	1	0.015	2.80
PK0608-1R5□	1.5	1	0.015	2.70
PK0608-2R2□	2.2	1	0.015	2.60
PK0608-2R7□	2.7	1	0.020	2.50
PK0608-3R3□	3.3	1	0.020	2.50
PK0608-3R9□	3.9	1	0.025	2.50
PK0608-4R7□	4.7	1	0.025	2.30
PK0608-5R6□	5.6	1	0.030	2.10
PK0608-6R8□	6.8	1	0.030	1.80
PK0608-8R2□	8.2	1	0.035	1.20
PK0608-100□	10	1	0.045	1.00
PK0608-120□	12	1	0.050	1.00
PK0608-150□	15	1	0.055	0.90
PK0608-180□	18	1	0.090	0.90
PK0608-220□	22	1	0.095	0.80
PK0608-270□	27	1	0.110	0.75
PK0608-330□	33	1	0.125	0.70
PK0608-390□	39	1	0.14	0.65
PK0608-470□	47	1	0.16	0.60
PK0608-560□	56	1	0.18	0.60
PK0608-680□	68	1	0.20	0.56
PK0608-820□	82	1	0.27	0.48
PK0608-101□	100	1	0.31	0.45
PK0608-121□	120	1	0.37	0.43
PK0608-151□	150	1	0.47	0.40
PK0608-181□	180	1	0.54	0.40
PK0608-221□	220	1	0.73	0.38
PK0608-271□	270	1	0.83	0.32
PK0608-331□	330	1	0.95	0.30
PK0608-391□	390	1	1.22	0.25

Note: □: Tolerance J: ±5% K: ±10% L: ±15% M: ±20%

Test Equipment Inductance:Hp4284A LCR Meter / DC Resistance:HP4338B Milliohms Meter.

Lead Type Fixed Inductors

◆ PK0810 Series:

Part Number	Inductance (μH)	Test Frequency (KHz)	DC Resistance (Ohms) Max	Rated Current (A) Max
PK0810-1R0□	1.0	1	0.015	4.50
PK0810-1R5□	1.5	1	0.020	4.50
PK0810-2R2□	2.2	1	0.020	4.20
PK0810-2R7□	2.7	1	0.020	4.20
PK0810-3R3□	3.3	1	0.020	4.00
PK0810-3R9□	3.9	1	0.020	4.00
PK0810-4R7□	4.7	1	0.025	4.00
PK0810-5R6□	5.6	1	0.025	4.00
PK0810-6R8□	6.8	1	0.025	4.00
PK0810-8R2□	8.2	1	0.035	3.80
PK0810-100□	10	1	0.040	3.80
PK0810-120□	12	1	0.040	3.20
PK0810-150□	15	1	0.045	2.80
PK0810-180□	18	1	0.060	2.50
PK0810-220□	22	1	0.070	2.10
PK0810-270□	27	1	0.085	2.00
PK0810-330□	33	1	0.090	1.80
PK0810-390□	39	1	0.10	1.60
PK0810-470□	47	1	0.11	1.50
PK0810-560□	56	1	0.15	1.30
PK0810-680□	68	1	0.19	1.00
PK0810-820□	82	1	0.21	0.90
PK0810-101□	100	1	0.24	0.80
PK0810-121□	120	1	0.26	0.80
PK0810-151□	150	1	0.31	0.75
PK0810-181□	180	1	0.38	0.70
PK0810-221□	220	1	0.43	0.65
PK0810-271□	270	1	0.49	0.63
PK0810-331□	330	1	0.66	0.60
PK0810-391□	390	1	0.79	0.58
PK0810-471□	470	1	0.91	0.52
PK0810-561□	560	1	1.13	0.50
PK0810-681□	680	1	1.30	0.40
PK0810-821□	820	1	1.53	0.30
PK0810-102□	1000	1	1.80	0.27

Note: □: Tolerance J: ±5% K: ±10% L: ±15% M: ±20%

Test Equipment Inductance:Hp4284A LCR Meter / DC Resistance:HP4338B Milliohms Meter.

Lead Type Fixed Inductors

◆ PK0912 Series:

Part Number	Inductance (μH)	Test Frequency (KHz)	DC Resistance (Ohms) Max	Rated Current (A) Max
PK0912-1R0□	1.0	1	0.015	5.00
PK0912-1R5□	1.5	1	0.015	5.00
PK0912-1R8□	1.8	1	0.015	5.00
PK0912-2R2□	2.2	1	0.015	5.00
PK0912-3R3□	3.3	1	0.020	4.80
PK0912-3R9□	3.9	1	0.020	4.80
PK0912-4R7□	4.7	1	0.020	4.50
PK0912-5R6□	5.6	1	0.025	4.00
PK0912-6R8□	6.8	1	0.025	3.90
PK0912-8R2□	8.2	1	0.025	3.50
PK0912-100□	10	1	0.030	3.40
PK0912-120□	12	1	0.030	3.20
PK0912-150□	15	1	0.040	3.00
PK0912-180□	18	1	0.045	2.80
PK0912-220□	22	1	0.050	2.70
PK0912-270□	27	1	0.055	2.50
PK0912-330□	33	1	0.055	2.50
PK0912-390□	39	1	0.06	2.00
PK0912-470□	47	1	0.07	1.80
PK0912-560□	56	1	0.08	1.70
PK0912-680□	68	1	0.09	1.50
PK0912-820□	82	1	0.11	1.40
PK0912-101□	100	1	0.16	1.20
PK0912-121□	120	1	0.17	1.10
PK0912-151□	150	1	0.20	1.00
PK0912-181□	180	1	0.22	0.90
PK0912-221□	220	1	0.26	0.80
PK0912-271□	270	1	0.39	0.70
PK0912-331□	330	1	0.45	0.50
PK0912-391□	390	1	0.49	0.45
PK0912-471□	470	1	0.62	0.43
PK0912-561□	560	1	0.64	0.40
PK0912-681□	680	1	0.79	0.38
PK0912-821□	820	1	1.34	0.35
PK0912-102□	1000	1	1.82	0.30

Note: □: Tolerance J: ±5% K: ±10% L: ±15% M: ±20%

Test Equipment Inductance:Hp4284A LCR Meter / DC Resistance:HP4338B Milliohms Meter.

Lead Type Fixed Inductors

◆ PK1012 Series:

Part Number	Inductance (μH)	Test Frequency (KHz)	DC Resistance (Ohms) Max	Rated Current (A) Max
PK1012-1R0□	1.0	1	0.010	6.00
PK1012-1R5□	1.5	1	0.010	6.00
PK1012-1R8□	1.8	1	0.015	6.00
PK1012-2R7□	2.7	1	0.015	5.50
PK1012-3R3□	3.3	1	0.015	5.50
PK1012-3R9□	3.9	1	0.020	5.00
PK1012-4R7□	4.7	1	0.020	5.00
PK1012-5R6□	5.6	1	0.025	4.80
PK1012-6R8□	6.8	1	0.025	4.80
PK1012-8R2□	8.2	1	0.025	4.50
PK1012-100□	10	1	0.025	4.50
PK1012-120□	12	1	0.025	4.30
PK1012-150□	15	1	0.035	4.30
PK1012-180□	18	1	0.040	4.00
PK1012-220□	22	1	0.045	3.70
PK1012-270□	27	1	0.045	3.50
PK1012-330□	33	1	0.055	3.00
PK1012-390□	39	1	0.060	2.50
PK1012-470□	47	1	0.080	2.30
PK1012-560□	56	1	0.085	2.00
PK1012-680□	68	1	0.095	2.00
PK1012-820□	82	1	0.11	1.80
PK1012-101□	100	1	0.14	1.70
PK1012-121□	120	1	0.16	1.50
PK1012-151□	150	1	0.18	1.40
PK1012-181□	180	1	0.25	1.30
PK1012-221□	220	1	0.28	1.00
PK1012-271□	270	1	0.42	0.90
PK1012-331□	330	1	0.54	0.80
PK1012-391□	390	1	0.60	0.80
PK1012-471□	470	1	0.66	0.70
PK1012-561□	560	1	0.74	0.60
PK1012-681□	680	1	0.84	0.50
PK1012-821□	820	1	1.08	0.50
PK1012-102□	1000	1	1.39	0.50

Note: □: Tolerance J: ±5% K: ±10% L: ±15% M: ±20%

Test Equipment Inductance:Hp4284A LCR Meter / DC Resistance:HP4338B Milliohms Meter.

Lead Type Fixed Inductors

◆ PK1016 Series:

Part Number	Inductance (μH)	Test Frequency (KHz)	DC Resistance (Ohms) Max	Rated Current (A) Max
PK1016-1R0□	1.0	1	0.010	9.00
PK1016-1R5□	1.5	1	0.015	9.00
PK1016-1R8□	1.8	1	0.015	9.00
PK1016-2R7□	2.7	1	0.015	9.00
PK1016-3R3□	3.3	1	0.015	8.50
PK1016-3R9□	3.9	1	0.015	8.00
PK1016-4R7□	4.7	1	0.020	7.50
PK1016-5R6□	5.6	1	0.025	7.50
PK1016-6R8□	6.8	1	0.025	7.50
PK1016-8R2□	8.2	1	0.025	7.20
PK1016-100□	10	1	0.030	7.20
PK1016-120□	12	1	0.030	7.00
PK1016-150□	15	1	0.035	6.50
PK1016-180□	18	1	0.035	6.30
PK1016-220□	22	1	0.045	5.50
PK1016-270□	27	1	0.050	4.50
PK1016-330□	33	1	0.070	4.00
PK1016-390□	39	1	0.070	3.80
PK1016-470□	47	1	0.070	3.60
PK1016-560□	56	1	0.080	3.20
PK1016-680□	68	1	0.090	3.00
PK1016-820□	82	1	0.095	2.60
PK1016-101□	100	1	0.12	2.50
PK1016-121□	120	1	0.14	2.30
PK1016-151□	150	1	0.17	2.10
PK1016-181□	180	1	0.19	2.00
PK1016-221□	220	1	0.25	1.80
PK1016-271□	270	1	0.34	1.50
PK1016-331□	330	1	0.45	1.50
PK1016-391□	390	1	0.51	1.30
PK1016-471□	470	1	0.56	1.20
PK1016-561□	560	1	0.64	1.00
PK1016-681□	680	1	0.71	1.00
PK1016-821□	820	1	1.01	0.90
PK1016-102□	1000	1	1.20	0.80

Note: □: Tolerance J: ±5% K: ±10% L: ±15% M: ±20%

Test Equipment Inductance:Hp4284A LCR Meter / DC Resistance:HP4338B Milliohms Meter.